

## ! ATTENTION

For legal and safety reasons, please refrain from calling your office, customer support, or safety personnel while driving.

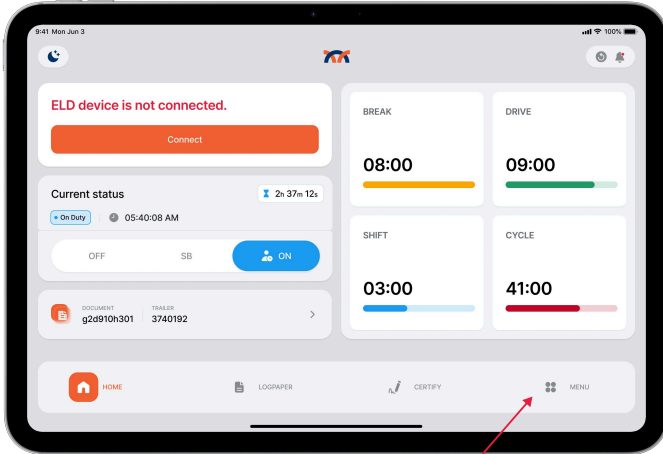

1. Tap **Menu** on the bottom right corner

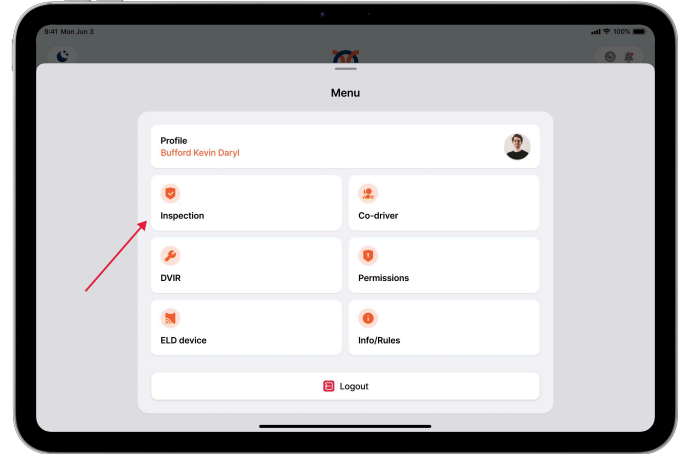

2. Select **Inspection** from list.

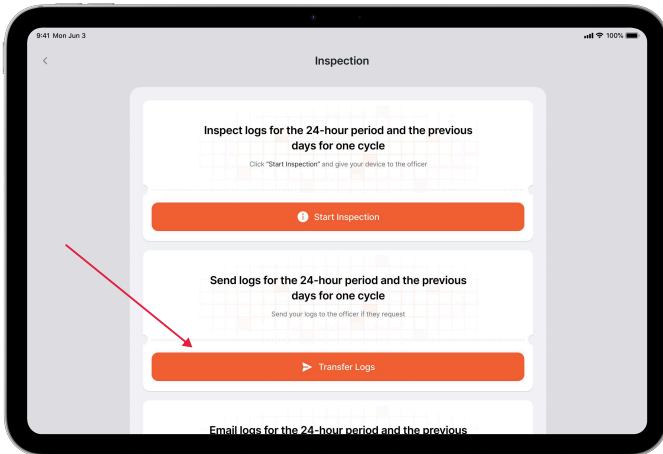

3. To send your log data to the DOT, tap on the **Transfer Logs** option.

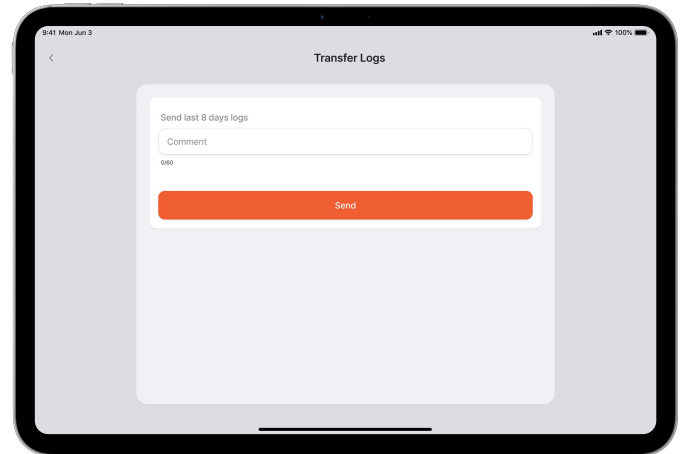

4. Enter the **comment** provided by the inspector, and tap the **Send** button.